

FORX's Smart Intralogistics Solution

FORX

XP15 B/B+

Pallet mover **LI-ION**
TECHNOLOGY
across factory and warehouse 1.5T

- Your best co-worker
- Stand alone installation
- Flexible to change application
- Plug-in battery design
- 2D visual navigation
- Maximum personal safety protection

ENERGY ADVANCE CO., LTD
www.forx.co.th



FEATURE

■ **XP15 B: A-B-C-...-A Loop with manual loading and unloading**

XP15 B transports pallets along the loop continuously and workers are allowed to load or unload goods manually on the way. Pause on pre-programmed work stations.

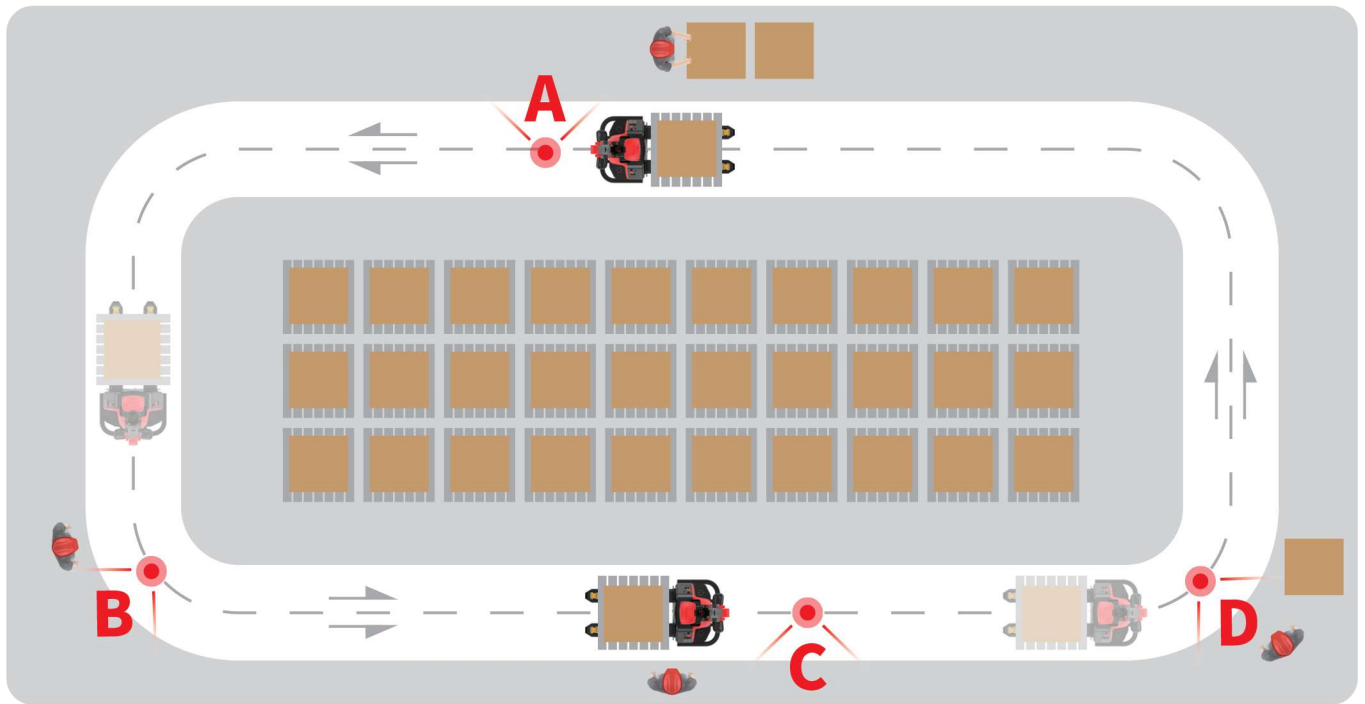

■ **XP15 B+: A-B-A with automatic unloading**

XP15-B+ starts with manual loading and unloads pallets automatically in the storage area or production. It requires minimum involvement of worker and delivers high process efficiency where transportation tasks need to be repeated permanently.

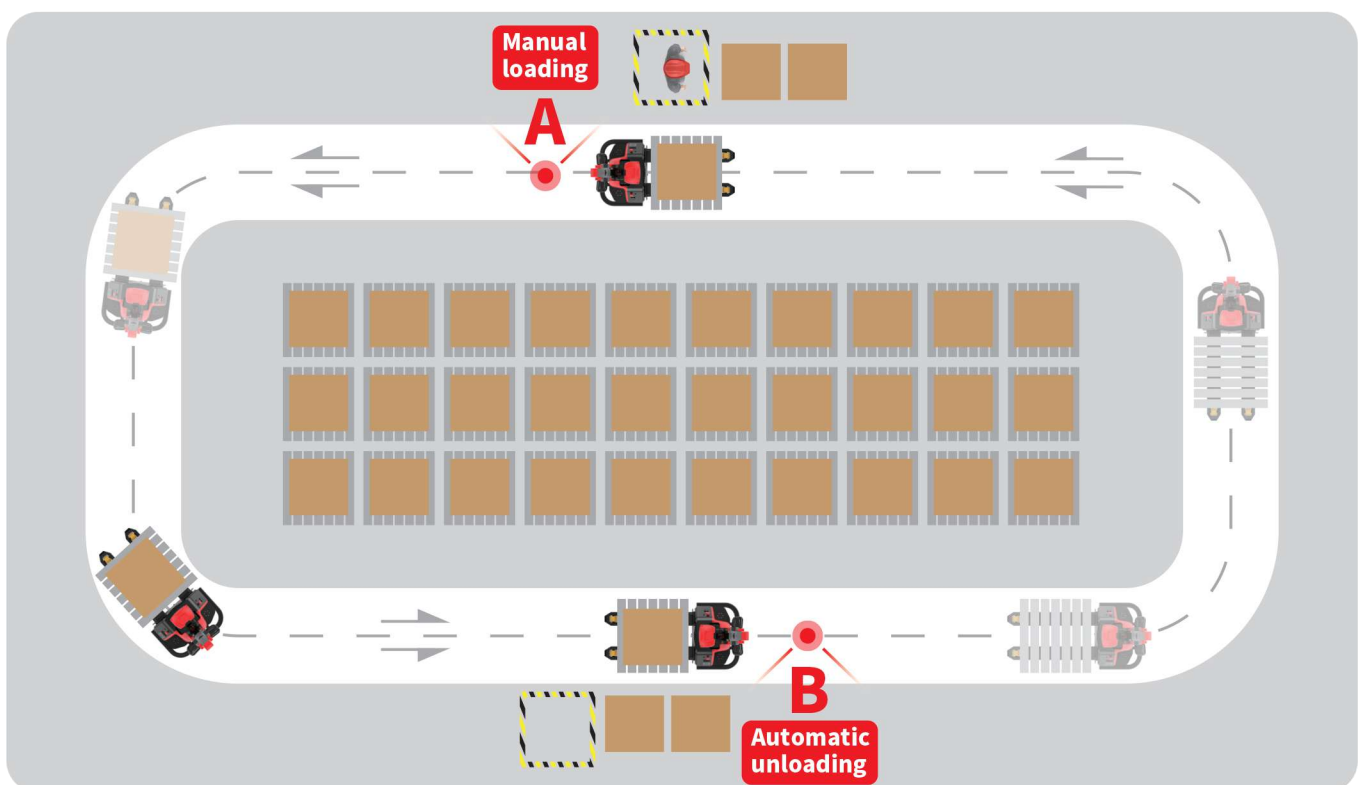

FEATURE

■ Your best co-worker

You can operate the XP15 as an autonomous mobile robot and an electric pallet truck. Switch between manual and automatic operation by the push of a button.



■ Stand alone installation

The XP15 is easy to set up for various applications without IT knowledge or specialized hardware and software.

■ Flexible to change application

The XP15 offers route settings and transportation task monitoring via bluetooth and you can add new routes and stations quickly on your phone.

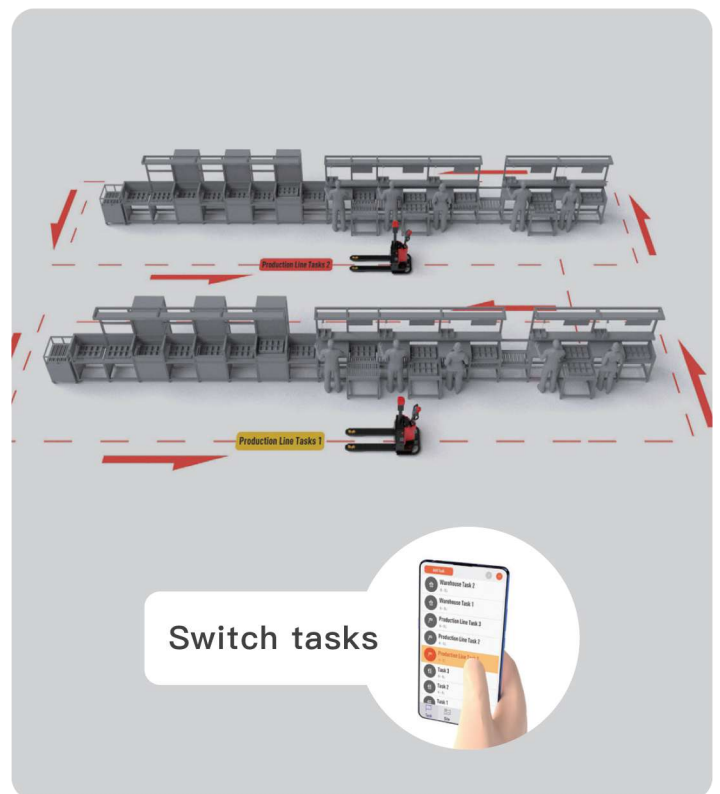
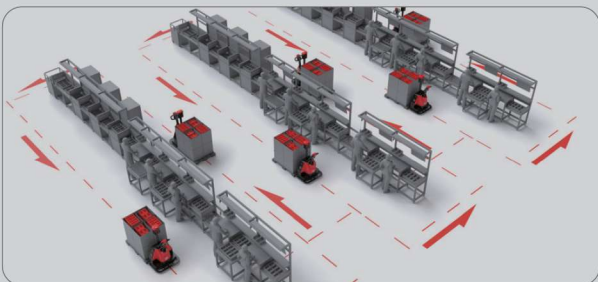

FEATURE

■ Plug-in battery design

The XP15 features plug-in battery design and adopts **FORX**'s standard battery box with 24V/60Ah Li-ion battery. This maximizes uptime and provides high availability and flexibility.



■ 2D visual navigation

FORX's in-house developed visual navigation technology provides XP15 with highly stable and adaptable navigation. Absolute positioning, with random labeling and visual navigation, the vehicle knows its position at all times to proceed its path.

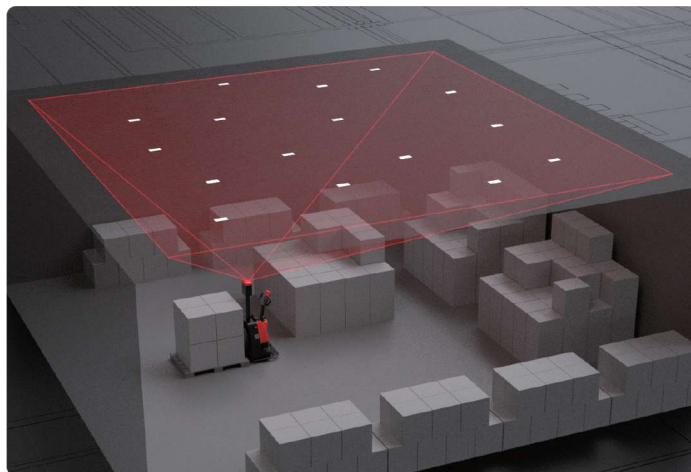

■ Maximum personal safety protection

The XP-15 is equipped with Bumper strips and Lidar detectors that prevent the truck from collision.

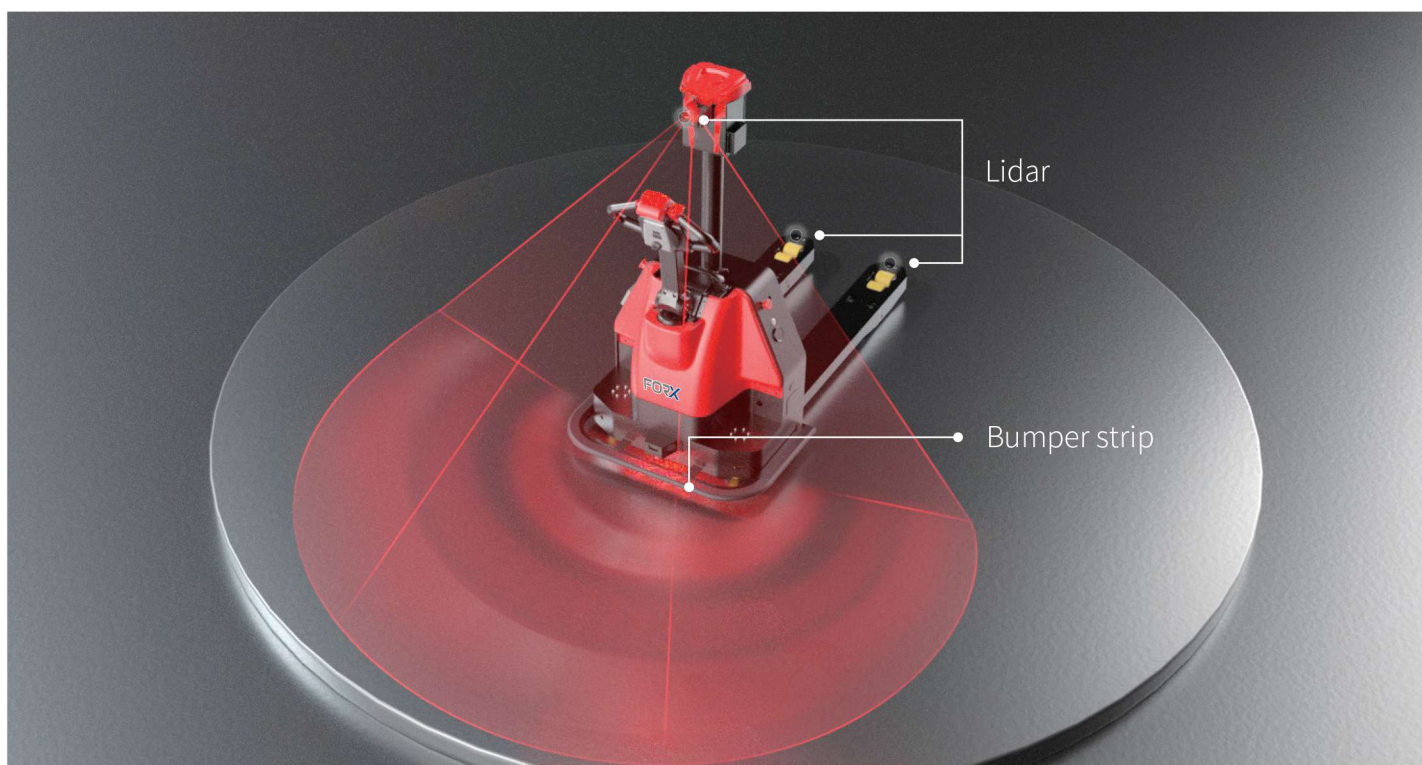

Pallet mover across factory and warehouse 1.5T

XP15 B/B+

| | | | | | |
|---------------------|--------|---|-------|-------|-----------------------|
| Distinguishing mark | 1.1 | Manufacturer | | | FORX |
| | 1.2 | Model designation | | | XP15 |
| | 1.3 | Drive | | | Electric |
| | 1.4 | Operator type | | | Pedestrian |
| | 1.5 | Load capacity | Q | kg | 1500 |
| | 1.6 | Load center distance | c | mm | 600 |
| | 1.8 | Load distance, centre of drive axle to fork | x | mm | 980 |
| | 1.9 | Wheelbase | y | mm | 1210 |
| Service weight | 2.1 | Service weight | | kg | 335 |
| | 2.2 | Axle loading, laden front/rear | | kg | 1150/510 |
| | 2.3 | Axle loading, unladen front/rear | | kg | 120/40 |
| Tyres/chassis | 3.1 | Tyre type | | | PU |
| | 3.2.1 | Tyre size, front | | mm | φ210*94 |
| | 3.3.1 | Tyre size, rear | | mm | 85*70 |
| | 3.4 | Additional wheels (castor wheels) | | mm | 74*30 |
| | 3.5 | Wheels, number front/rear (x=drive wheels) | | mm | 1,2/4 |
| | 3.6.1 | Tread width, front | b10 | mm | 504 |
| | 3.7.1 | Tread width, rear | b11 | mm | 430 |
| Dimensions | 4.4 | Lift height | h3 | mm | 95 |
| | 4.9 | Height of tiller handle in drive position min./max. | h14 | mm | — |
| | 4.15 | Lowered height | h13 | mm | 90 |
| | 4.19 | Overall length | l1 | mm | 1695 |
| | 4.20 | Length to face of forks | l2 | mm | 545 |
| | 4.21 | Overall width | b1/b2 | mm | 842 |
| | 4.22 | Fork dimensions | s/e/l | mm | 55X170X1220 |
| | 4.25 | Distance between fork-arms | b5 | mm | 540 |
| | 4.32 | Ground clearance, center of wheelbase | m2 | mm | 30 |
| | 4.34.1 | Aisle width for pallets 1000×1200 crossways | Ast | mm | 2300 |
| | 4.34.2 | Aisle width for pallets 800×1200 lengthways | Ast | mm | 2160 |
| | 4.35 | Turning radius | Wa | mm | 1500 |
| Performance data | 5.1 | Travel speed, laden/unladen | | km/h | 4.5/5 |
| | 5.2 | Lifting speed, laden/unladen | | m/s | 0.017/0.02 |
| | 5.3 | Lowering speed, laden/unladen | | m/s | 0.09/0.06 |
| | 5.8 | Max. gradeability, laden/unladen | | % | 6/16 |
| | 5.10 | Service brake | | | Electromagnetic |
| Electric-engine | 6.1 | Drive motor rating S2 60 min | | kW | 0.9 |
| | 6.2 | Lift motor rating at S3 15% | | kW | 0.8 |
| | 6.4 | Battery voltage/nominal capacity | | V/Ah | 24/60 |
| | 6.5 | Battery weight | | kg | 14 |
| Addition data | 8.1 | Type of drive control | | | AC |
| | 10.5 | Steering design | | | Electric |
| | 10.7 | Sound pressure level at the driver's ear | | dB(A) | <70 |
| | 10.11 | Indoor/Outdoor | | | Indoor |
| | 10.12 | Safety notification | | | Horn |
| | 10.13 | Safety protection | | | Physical bumper strip |
| | | | | | Lidar |
| | | | | | Emergency stop button |
| | 10.14 | Positioning | | | 2D visual navigation |
| | 10.15 | Parking accuracy | | mm | ±20 |
| | 10.16 | Navigation accuracy | | mm | ±20 |
| | 10.17 | Battery type | | | Li-ion battery |

If there are improvements of technical parameters or configurations, no further notice will be given.
The diagram shown may contain non-standard configurations.

